

SILT FENCE CONSTRUCTION SPECIFICATIONS

- SILT FENCE SHALL BE CONSTRUCTED BEFORE UPSLOPE LAND DISTURBANCE BEGINS.
- THE HEIGHT OF A SILT FENCE SHALL NOT EXCEED 36 INCHES.
- PONDING HEIGHT SHALL NEVER EXCEED 18". THE FENCE LINE SHALL FOLLOW THE CONTOUR AS CLOSELY AS POSSIBLE.
- IF POSSIBLE, THE FILTER FABRIC SHALL BE CUT FROM A CONTINUOUS ROLL TO AVOID THE USE OF JOINTS. WHEN JOINTS ARE NECESSARY, FILTER CLOTH SHALL BE SPLICED ONLY AT A SUPPORT POST, WITH A MINIMUM 6-INCH OVERLAP AND BOTH ENDS SECURELY FASTENED TO THE POST.
- POSTS SHALL BE SPACED A MAXIMUM OF 10 FEET APART AND DRIVEN SECURELY INTO THE GROUND (MINIMUM OF 12 INCHES). WHEN EXTRA STRENGTH FABRIC IS USED WITHOUT THE WIRE SUPPORT FENCE, POST SPACING SHALL NOT EXCEED 8 FEET. TURN THE ENDS OF THE FENCE UPRIIL.
- A TRENCH SHALL BE EXCAVATED APPROXIMATELY 4 INCHES WIDE AND 6 INCHES DEEP ALONG THE LINE OF POSTS AND UPSLOPE FROM THE BARRIER.
- SEE TABLE "A" BELOW FOR SUGGESTED FILTER FABRIC SPECIFICATIONS.
- THE TRENCH SHALL BE BACKFILLED AND THE SOIL COMPACTED OVER THE TOE OF THE FILTER FABRIC.
- SILT FENCES PLACED AT THE TOE OF A SLOPE SHALL BE SET AT LEAST 6 FEET FROM THE TOE IN ORDER TO INCREASE PONDING VOLUME.
- SILT FENCES SHALL BE REMOVED WHEN THEY HAVE SERVED THEIR USEFUL PURPOSE, BUT NOT BEFORE THE UPSLOPE AREA HAS BEEN PERMANENTLY STABILIZED, AND ANY SEDIMENT STORED BEHIND THE SILT FENCE HAS BEEN REMOVED.

INSPECTION AND MAINTENANCE

- SILT FENCES AND FILTER BARRIERS SHALL BE INSPECTED WEEKLY AND AFTER EACH SIGNIFICANT STORM (1" IN 24 HR.). ANY REQUIRED REPAIRS SHALL BE MADE IMMEDIATELY.
- SEDIMENT SHALL BE REMOVED WHEN IT REACHES 1/3 HEIGHT OF THE FENCE OR 9 INCHES MAXIMUM.
- THE REMOVED SEDIMENT SHALL CONFORM WITH THE EXISTING GRADE AND BE VEGETATED OR OTHERWISE BE STABILIZED.

VALUES		
FABRIC PROPERTIES	TABLE "A"	TEST METHOD
GRAB TENSILE STRENGTH	90 lb. min.	ASTM 1682
MULLEN BURST STRENGTH	190 psi min.	ASTM D 3756
SLURRY FLOW RATE	0.3 gal/min/ft max.	
EQUIVALENT OPENING SIZE	40-80	US Std. Sieve CW-02215
ULTRAVIOLET RADIATION STABILITY	90% min.	ASIM-G-26

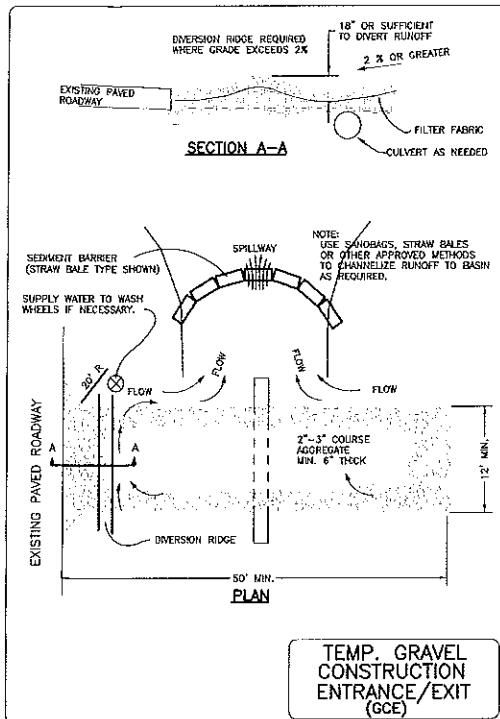

TEMPORARY GRAVEL CONSTRUCTION ENTRANCE/EXIT CONSTRUCTION SPECIFICATIONS

- THE AGGREGATE SIZE FOR CONSTRUCTION OF THE PAD SHALL BE 2-TO 3-INCH STONE. PLACE THE GRAVEL TO THE SPECIFIC GRADE AND DIMENSIONS SHOWN ON THE PLANS AND SMOOTH IT.
- THE THICKNESS OF THE PAD SHALL NOT BE LESS THAN 6 INCHES. USE GEOTEXTILE FABRICS, IF NECESSARY, TO IMPROVE STABILITY OF THE FOUNDATION IN LOCATIONS SUBJECT TO SEEPAGE OR HIGH WATER TABLE. GEOTEXTILE SHALL HAVE A GRAB TENSILE STRENGTH OF 200 LB. AND A MULLEN BURST STRENGTH OF AT LEAST 190 LB.
- THE WIDTH OF THE PAD SHALL NOT BE LESS THAN THE FULL WIDTH OF ALL POINTS OF INGRESS OR EGRESS AND IN ANY CASE SHALL NOT BE LESS THAN 12 FEET WIDE.
- THE LENGTH OF THE PAD SHALL BE AS REQUIRED, BUT NOT LESS THAN 50 FEET.
- LOCATE CONSTRUCTION ENTRANCES AND EXITS TO LIMIT SEDIMENT LEAVING THE SITE AND TO PROVIDE FOR MAXIMUM UTILITY BY ALL CONSTRUCTION VEHICLES. AVOID ENTRANCES WHICH HAVE STEEP GRADES AND ENTRANCES AT CURVES IN PUBLIC ROADS.
- THE ENTRANCE SHALL BE MAINTAINED IN A CONDITION THAT WILL PREVENT TRACKING OR FLOWING OF SEDIMENT ONTO PUBLIC RIGHTS OF WAY. THIS MAY REQUIRE PERIODIC TOP DRESSING WITH ADDITIONAL STONE AS CONDITIONS DEMAND, AND REPAIR AND/OR CLEANOUT OF ANY MEASURES USED TO TRAP SEDIMENT.
- ALL SEDIMENT SPILLED, DROPPED, WASHED OR TRACKED ONTO PUBLIC RIGHTS-OF-WAY SHALL BE REMOVED IMMEDIATELY. PROVIDE DRAINAGE TO CARRY WATER TO A SEDIMENT TRAP OR OTHER SUITABLE OUTLET.
- WHEN NECESSARY, WHEELS SHALL BE CLEANED TO REMOVE SEDIMENT PRIOR TO ENTRANCE ONTO PUBLIC RIGHTS-OF-WAY. WHEN WASHING IS REQUIRED, IT SHALL BE DONE ON AN AREA STABILIZED WITH CRUSHED STONE THAT DRAINS INTO AN APPROVED SEDIMENT TRAP OR SEDIMENT BASIN.
- ALL SEDIMENT SHALL BE PREVENTED FROM ENTERING ANY STORM DRAIN, DITCH OR WATERCOURSE THROUGH USE OF SAND BAGS, GRAVEL, STRAW BALES, OR OTHER APPROVED METHODS.
- A CURBLET SHALL BE CONSTRUCTED UNDER THE ENTRANCE IF NEEDED TO PREVENT SURFACE WATER FLOWING ACROSS THE ENTRANCE AND FROM BEING DIRECTED OUT ONTO PAVED SURFACES.

INSPECTION AND MAINTENANCE

- MAINTAIN THE GRAVEL PAD IN A CONDITION TO PREVENT MUD OR SEDIMENT FROM LEAVING THE CONSTRUCTION SITE.
- REPLACE GRAVEL MATERIAL WHEN SURFACE Voids ARE VISIBLE.
- AFTER EACH RAINFALL, INSPECT ANY STRUCTURE USED TO TRAP SEDIMENT AND CLEAN IT OUT AS NECESSARY.
- IMMEDIATELY REMOVE ALL OBJECTIONABLE MATERIALS SPILLED, WASHED, OR TRACKED ONTO PUBLIC ROADWAYS. REMOVE ALL SEDIMENT DEPOSITED ON PAVED ROADWAYS WITHIN 24 HOURS.

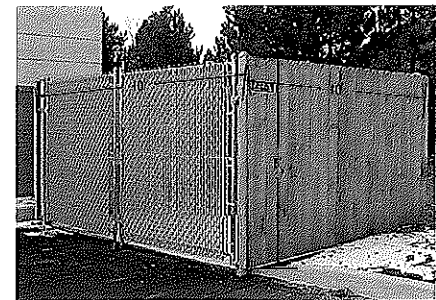

DUMPSTER ENCLOSURE DETAIL

RECEIVED

SEP 13 2017

CLEARCREEK TOWNSHIP ZONING DEPT.

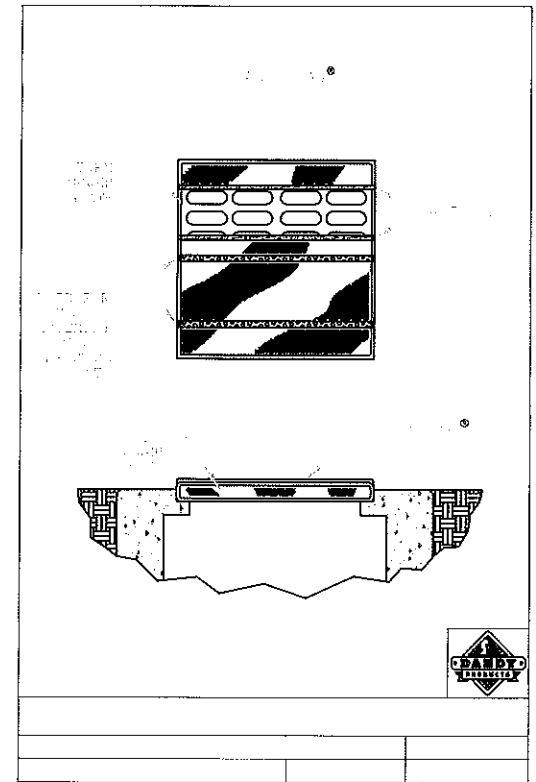

NOTE: THE DANDY BAGS WILL BE MANUFACTURED IN THE U.S.A. FROM A WOVEN MONOFILAMENT FABRIC THAT MEETS OR EXCEEDS THE FOLLOWING SPECIFICATIONS:

Mechanical Properties	Test Method	Units	MIN.	MAX.
Grab Tensile Strength	ASTM D 4833	klb (lbs)	1.82 (2665)	2.00 (2900)
Grab Tensile Elongation	ASTM D 4833	%	74	10
Puncture Strength	ASTM D 4833	klb (lbs)	0.40 (560)	
Mullen Burst Strength	ASTM D 3756	klb (psi)	397	(450)
Impacted Tear Strength	ASTM D 4253	klb (lbs)	0.51 (115)	0.33 (72)
UV Resistance	ASTM D 4355	%	90	
Apparent Opening Size	ASTM D 4251	Min (US Std Sieve)	0.425 (40)	
Flow Rate	ASTM D 4491	l/min/m ² (gal/min/ft ²)	0.907 (145)	
Permeability	ASTM D 4491	Sec	2.1	

*Note: All Dandy Bags can be ordered with our optional oil absorbent pillows

PLANT SCHEDULE

- SHRUBS**
131 - GOLDEN BARBERRY (24" HIGH) - 3'-4H, 4'-5" SP AT MATURITY
- TREES**
29 - CRIMSON SENTRY MAPLES (3" CALIPER) - 25H, 15" SP AT MATURITY

SECTION
*NOTE: PREPARE PLANTING MIXTURE PER SPECIFICATIONS, SEE PREPARATION & PLANTING NOTES

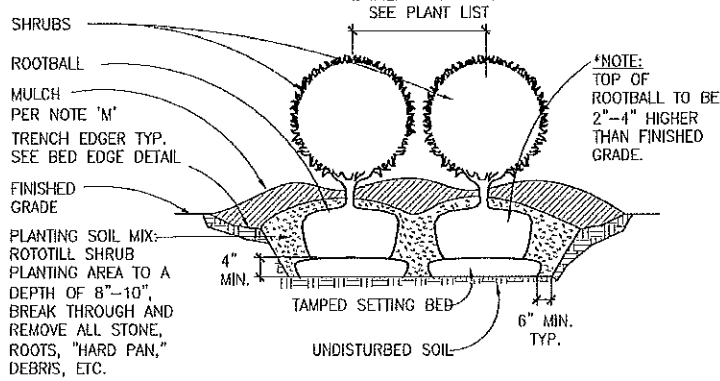

2 SHRUB PLANTING DETAIL
SCALE: NOT TO SCALE

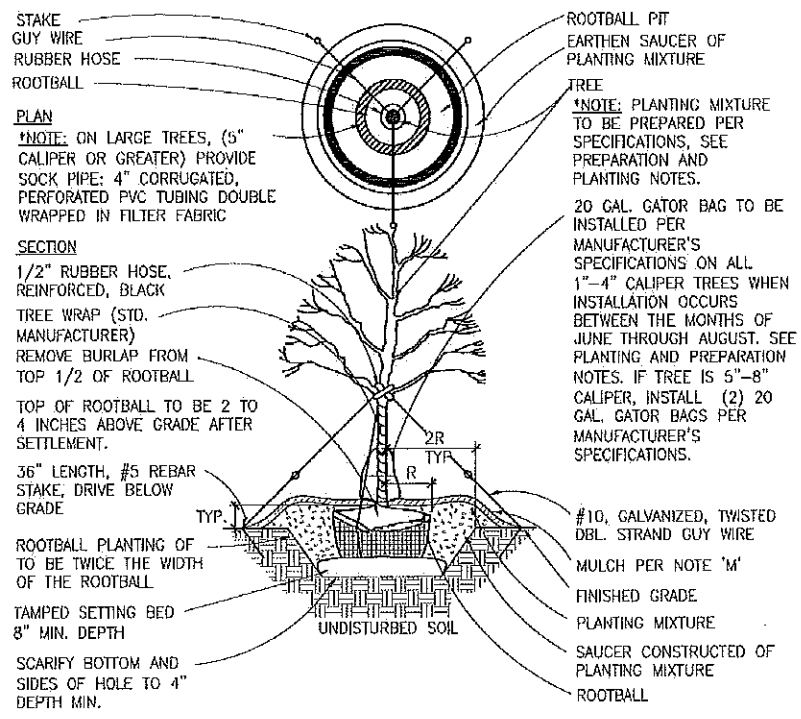

1 TREE PLANTING DETAIL - DECIDUOUS
SCALE: NOT TO SCALE



2 WORKING DAYS BEFORE YOU DIG
CALL TOLL FREE 800-362-2764
OHIO UTILITIES PROTECTION SERVICE

SCALE: N/A
DATE: 06-26-17
DRAWN: JLL
DESIGNED: JLL
CHECKED:



REVISIONS:
2.
3.
4.
PROJECT: 160676 SHEET: 1 OF 1

DETAILS
RED LION MARATHON
SECTION 15, TOWN 3, RANGE 4
CLEARCREEK TOWNSHIP
WARREN COUNTY, OHIO

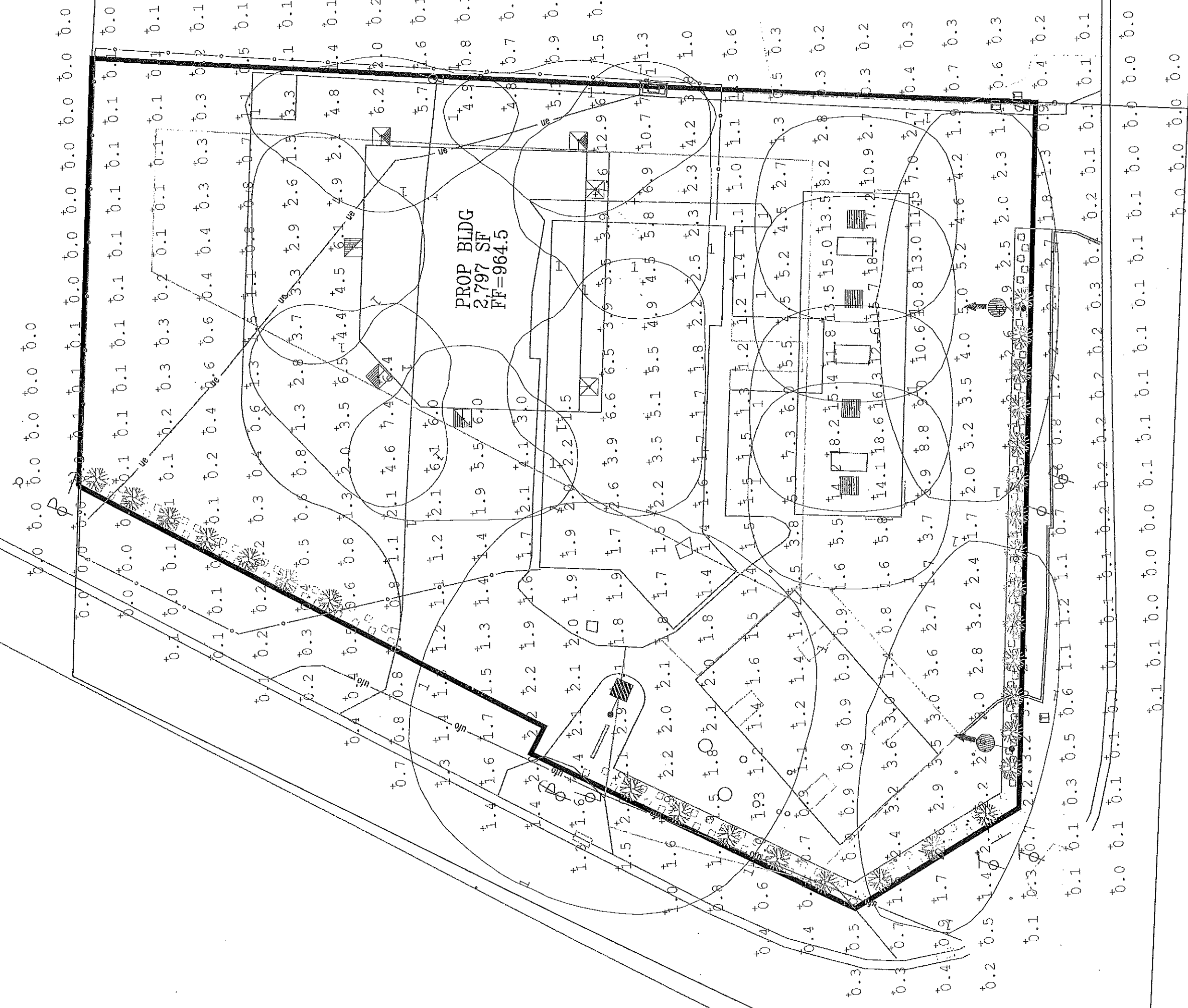

PROP BLDG
2,797 SF
FF=964.5

Calculation Summary
Label
FUEL CANOPY SUMMARY
OVERALL PARKING SUMMA

Luminaire Schedule